

# YUJA – CREATING A VIDEO QUIZ



Teaching and Learning Support Service (TLSS), uOttawa

## CONTEXT

**YuJa** is a cloud-based video capture, editing and streaming service available to the entire university community.

The video software **YuJa** allows professors to insert a quiz into a video. The following guide explains the features for creating a video quiz within YuJa. **Note** – To create a video quiz in YuJa, a video must be uploaded to **My Media** tab or have been previously recorded in YuJa.

To learn how to upload or record a video, please visit our other resource.

## SECTION 1: SETTING UP A VIDEO QUIZ

1. Within the **YuJa** interface in Virtual Campus (Brightspace), navigate to the right side of the video you want to add a quiz to and click on **More**.

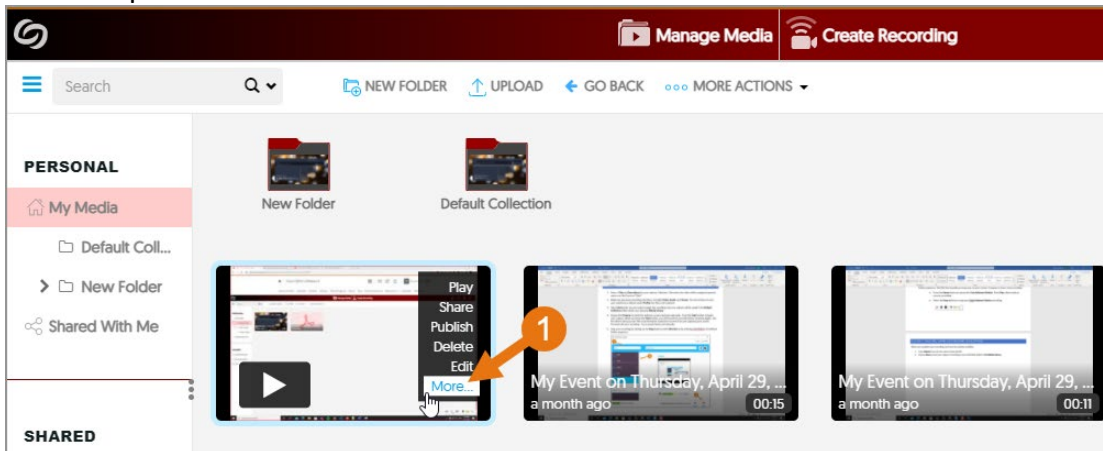

2. The **YuJa** interface opens the general settings and options window of the video.

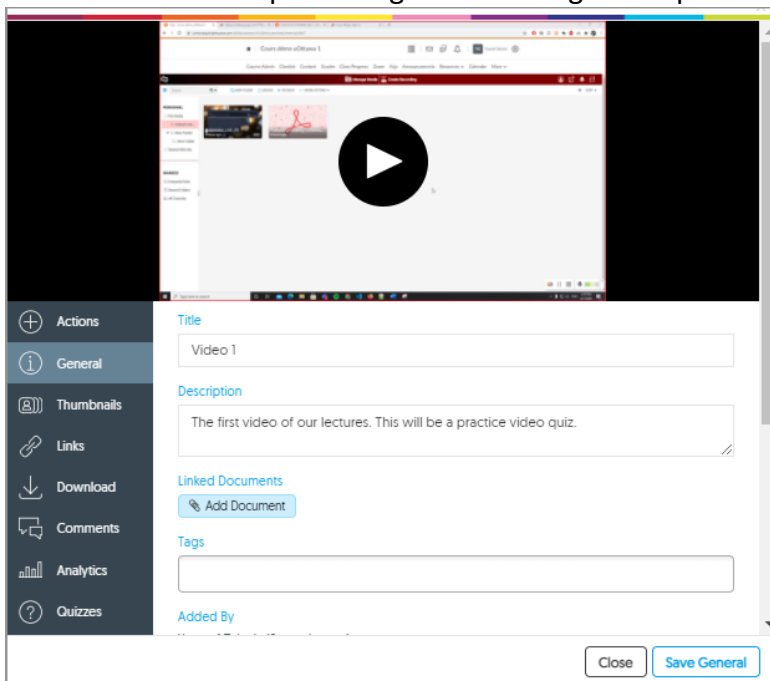

3. Scroll down on the left-hand side of pop-up page, click on **Quizzes**, and then select **Create Quiz**.

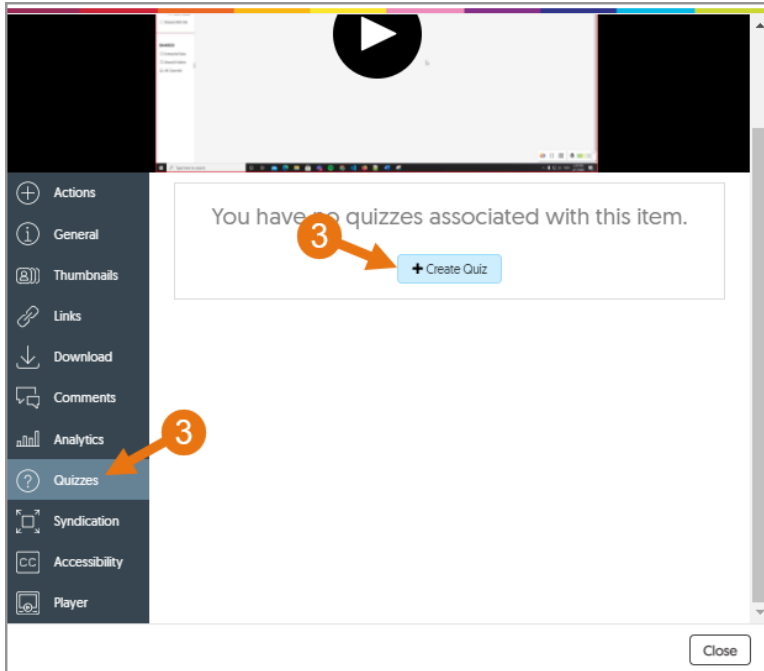

4. This action will bring you to the quiz interface where you will be able to create your video quiz. On top of the video provide a name for the quiz where it is written **Enter Quiz Name**.

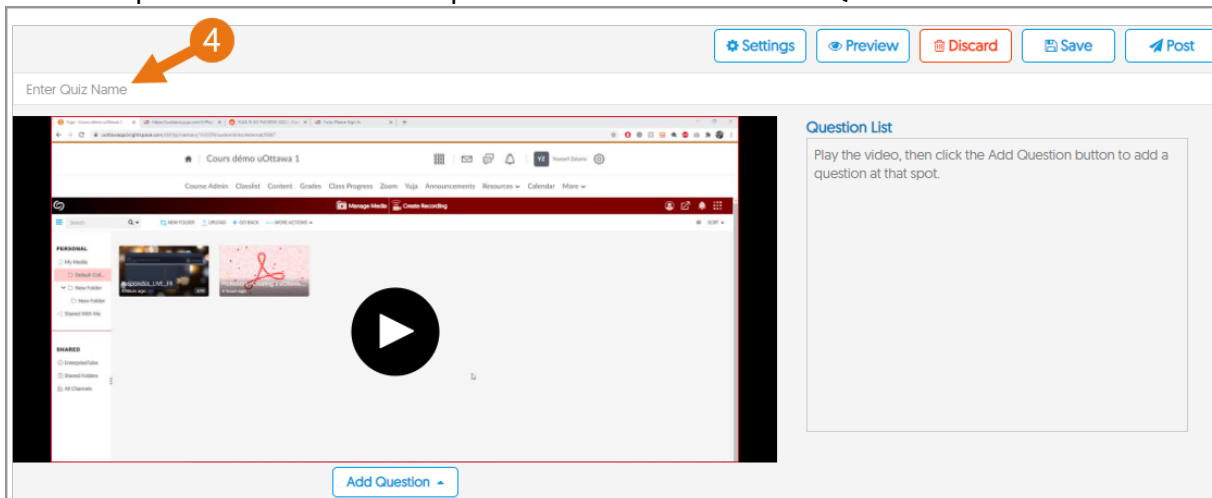

## SECTION 2: ADD A QUESTION

The YuJa software tool has six different types of questions available when you create a quiz. This section will go in detail and explain the different types of questions and how to add questions to a quiz.

1. Click the **Play** button, once you have reached the required spot where you want to enter a question click the **Pause** button.
2. Then click **Add Question** where there will be an option to select what type of question you choose to use.

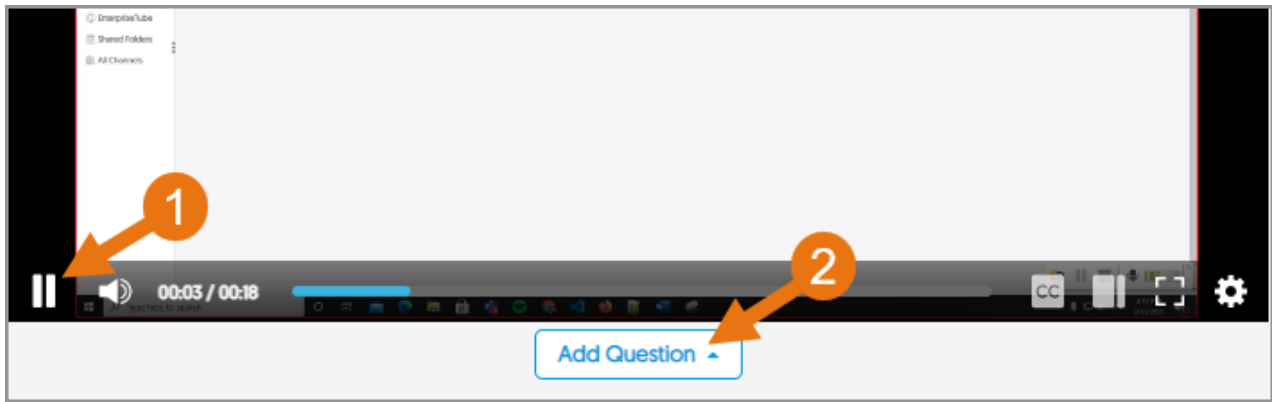

- a. **Multiple Choice** – Gives the user the option to select one correct answer out of all available answers.
- b. **Select Multiple** – Gives the user the option to select multiple correct answers out of all the available answers.
- c. **Short Answer** – Gives the user the option to type in a short paragraph answer.
- d. **True or False** – Gives the user the option to pick **True** or **False** in response to a question.
- e. **Reflective Pause** – Provides the user time for thought or reflection.
- f. **Decision Point** – Provides customization in the linear progression of a video based on the response of a question.

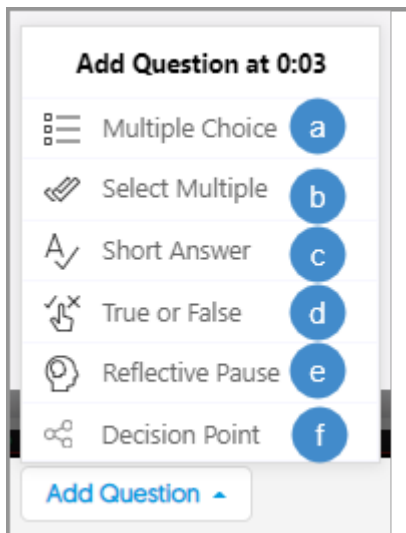

3. Once the type of question is selected, a prompt window will show the settings for that specific type of question.
  - a. **Multiple Choice:**
    - i. **Time and Points:** Shows when the video is paused and how many points to give this question.
    - ii. **Question box:** Write the question in the box with the HTML editor. Also, there is a preview button to view the question as a student.
    - iii. **Hint:** Enter a hint or leave blank if no hint is desired.
    - iv. **Answers:** Enter the answers in the boxes below, you can add more boxes by clicking on the **Add Option** button. Click on the circle on the left side to select the correct answer.
    - v. Click the **Save** button to save the question.

- b. **Select Multiple:**
  - i. **Time and Points:** Shows when the video is paused and how many points to give this question.
  - ii. **Question box:** Write the question in the box with the HTML editor. Also, there is a preview button to view the question as a student.
  - iii. **Hint:** Enter a hint or leave blank if no hint is desired.
  - iv. **Answer:** Enter the right and wrong answers in the boxes below, the **Add Option** button adds more boxes. Click on the left side to select the one or more correct answers.
  - v. Click the **Save** button to save the question.
- c. **Short Answer:**
  - i. **Time and Points:** Shows when the video is paused and how many points to give this question.
  - ii. **Question box:** Write the question in the box with the HTML editor. Also, there is a preview button to view the question as a student.
  - iii. **Answer:** There are no answers since the student will be writing an answer.
  - iv. Click the **Save** button to save the question.
- d. **True or False:**
  - i. **Time and Points:** Shows when the video is paused and how many points to give this question.
  - ii. **Question box:** Write the question in the box with the HTML editor. Also, there is a preview button to view the question as a student.
  - iii. **Answer:** Click **True** or **False** on the left side to correspond with the question.
  - iv. Click the **Save** button to save the question.
- e. **Reflective Pause:**
  - i. **Time:** Shows when the video is paused.
  - ii. **Question box:** Write the reflective question in the box with the HTML editor. Also, there is a preview button to view the question as a student.
  - iii. Click the **Save** button to save the question.
- f. **Decision Point:**
  - i. **Time and Points:** Shows when the video is pause and how many points to give this question.
  - ii. **Use as ending decision:** Check this box off to allow students to complete that question and submit the quiz.
  - iii. **Enter option here:** Enter the desired possible options for that **Decision Point**.
  - iv. **Jump point:** Click on the arrow pointing downwards below the delete icon on the right side. Add the jump point time where the student will be redirected to upon choosing this option. Check all the boxes that will be added to this question.
  - v. Click the **Save** button to save the question.

## SECTION 3: ADJUSTING THE PROPERTIES OF A QUIZ

To adjust the settings of a quiz:

1. In the top right corner above the quiz name bar, click on **Settings**, here you will be able to modify the **Quiz Options** as well as the **Gradebook Options**.

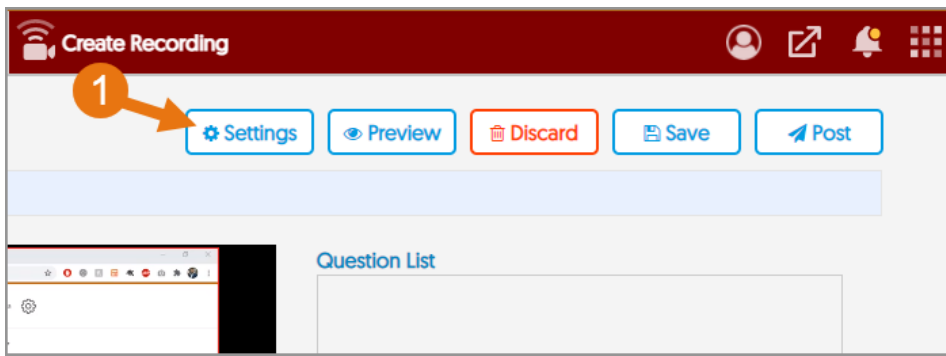

2. In the **Customize experience** field there are two preferences. First, click on the box besides **Provide Answer Right Away** to provide the students with an answer after completing the question in the quiz. Secondly, click on the box besides **Disable Fast Forwarding** to block the students from skipping ahead in the quiz.
3. In the **Gradebook Options** there are three fields of options, **Recording Quiz Attempts**, **Maximum Attempts** and **LMS Quiz Attempts**.
4. There are two options for the **Recording Quiz Attempts** field, **Record All Attempts** which will keep track of all attempts or **Record Only Most Recent Attempt** this option will only record the latest attempt.
5. To grant unlimited attempts click on **Allow Unlimited Attempts** or else enter the number of attempts allowed in the **Maximum Attempts Allowed** box.
6. The **LMS Quiz Attempts** is a necessary step to link the grade to the LMS (Learning Management System) platform used (i.e. Virtual Campus – Brightspace). There are three options in this field: **Send First Attempt to LMS** which will send the first attempt to the LMS, **Send Most Recent Attempt to LMS** which will send the latest attempt to the LMS and finally, **Send Highest Score Attempt to LMS** this option will send the attempt with the best score to the LMS.
7. Once all the settings are set to the desired options, click on the **Save** button to save the settings.

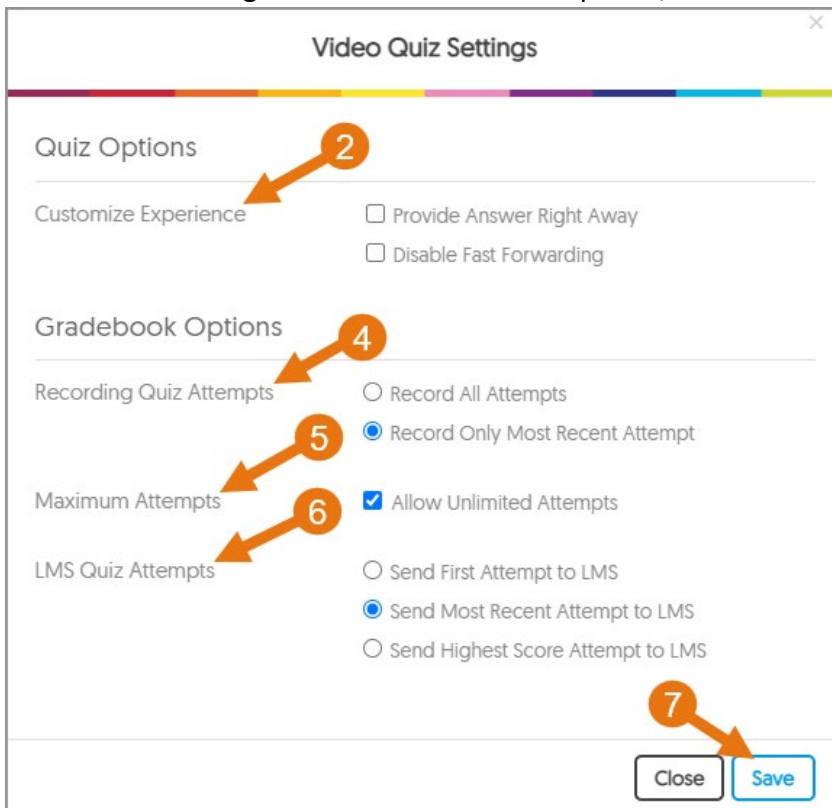

## SECTION 4: PREVIEW THE QUIZ AS A STUDENT

Once you have finished adding all the questions and finalizing the settings of the video quiz, YuJa gives the creator an option to view the video quiz as a student to assure the video quiz is to your liking.

1. Click on the **Preview** button to the right of the **Settings** button to view the quiz as a student.

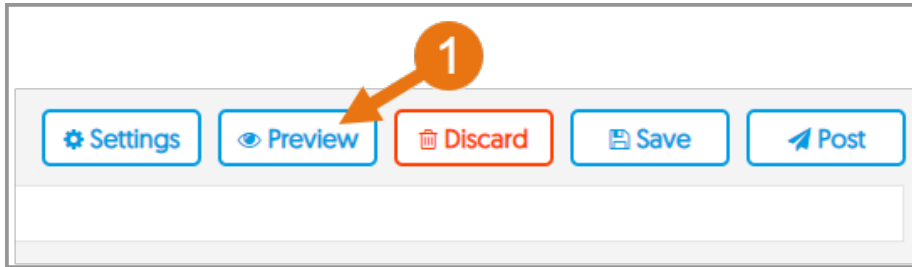

2. Press **Play** on the video to take the quiz. The video will automatically pause to answer the questions.
3. Once the video has finished the **Exit Preview** button will bring the user back to the quiz homepage.

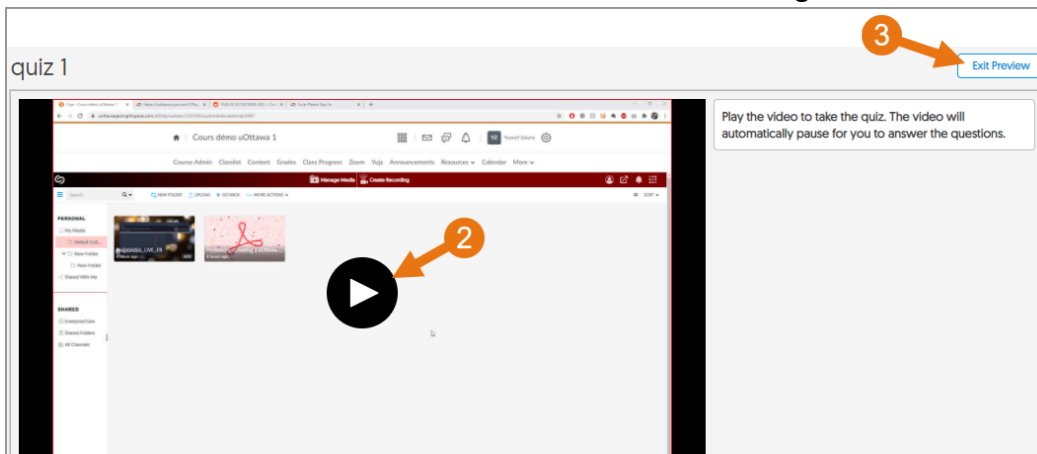

## SECTION 5: FINALIZING THE QUIZ

1. After reviewing the quizzes question and properties, click on the **Save** button to save the quiz.
2. If you wish to discard any unsaved changes to the quiz, click on **Discard**.

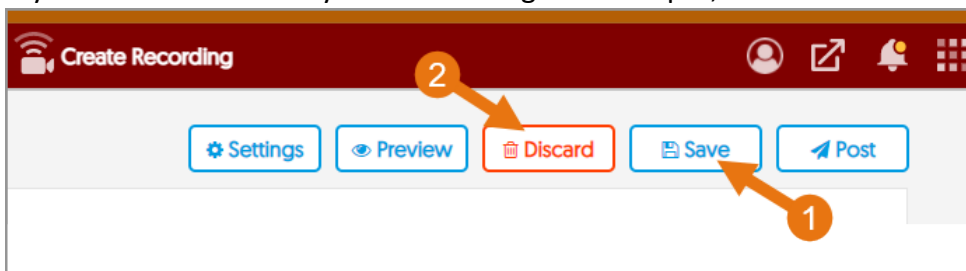

3. Finally, the **Post** button allows you to post the quiz on YuJa.
  - a. Once you have clicked on the **Post** button. You can choose a date to open the quiz and to close the quiz. This will give the students a period to access and complete the quiz.
  - b. The last field lets you select which group or groups to post this quiz too. Click on the box or boxes of the groups you wish to post this quiz too.
  - c. Click the **Post** button to post the quiz.

### Post Quiz ×

---

Title: quiz 1

Quiz Opens:

Quiz Closes:

No Close Date

Select group to post quiz to:

- Université d'Ottawa | University of Ottawa
- Brightspace Test Course Space
- Demo - Course

The diagram features three callouts: 'a' points to the 'Quiz Opens' field, 'b' points to the 'Select group to post quiz to:' section, and 'c' points to the 'Post' button.